

# How To Do a COVID-19 Test

Using *QuickVue At-Home OTC COVID-19 Test*

## ABOUT

This is a simplified guide for the *QuickVue At-Home OTC COVID-19 Test* kit. **For complete information**, please refer to the **Instruction Sheet** and the **Patient Fact Sheet** in the kit. This product has FDA Emergency Use Authorization.



For a video about how to do the test, go to [quickvueathome.com/#video\\_testkit-2](https://quickvueathome.com/#video_testkit-2)

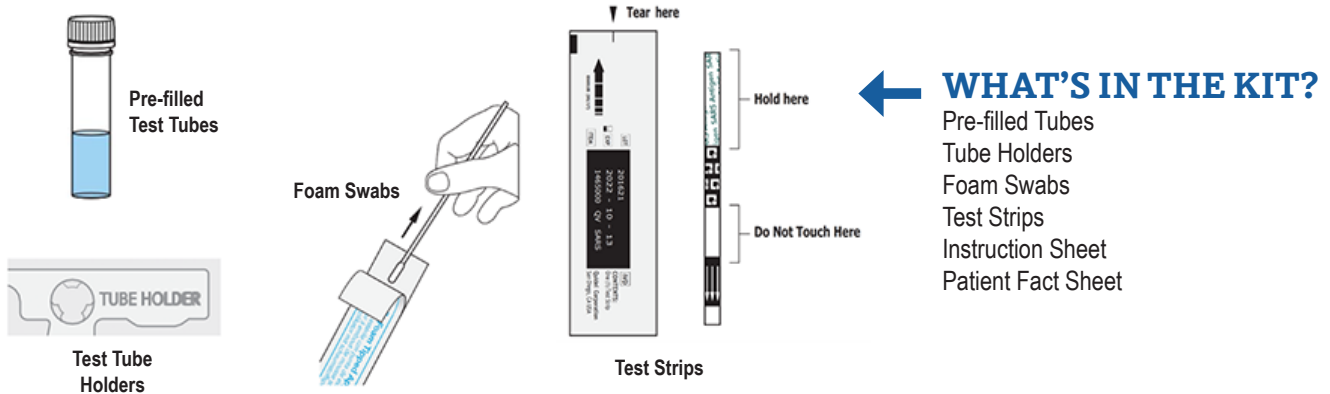

## WHAT ELSE DO YOU NEED?

Watch or timer (not included)  
Being exact about time is very important for this test!

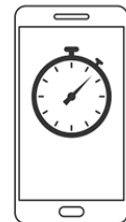

## TO START THE TEST

**Wash your hands** and place the kit on a **flat and clean surface**. Make sure there is **good light** in the room. If you are doing the test on another person, use a **face mask**. Open the kit and make sure that all the items listed above are there. **Get your timer or watch** and **follow the step-by-step instructions** on the other side.

# Doing The Test

1

Take off the cap from one of the tubes and put it in the tube holder.

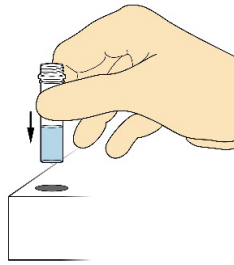

DO NOT TOUCH THE SWAB HEAD.

2

Peel open the wrapper from the swab. Do not touch the swab head.

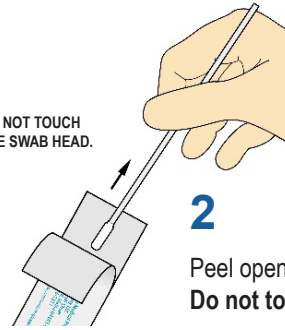

3

Insert the swab about 1/2 to 3/4 inch into one nostril and rub it around the inside walls at least 4 times. Using the same swab, repeat in the other nostril. This will take about 15 seconds.

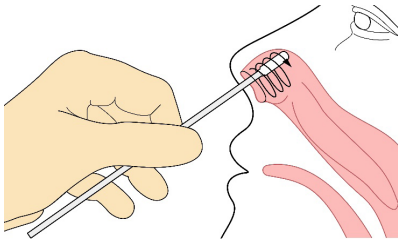

4

Right after getting the sample from the nose, put the swab into the open tube. Be sure the swab is touching the bottom of the tube. Stir swab 3 or 4 times.

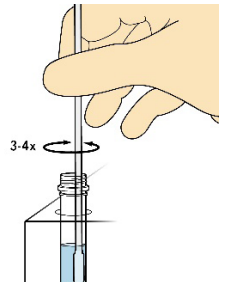

5

Leave the swab in the tube for at least 1 minute. (Use timer or watch!) Wrong results may occur if you leave the swab in for too short or too long.

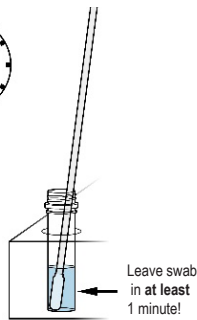

6

After 1 minute, take the swab out of the tube, rubbing the swab head against the wall of the tube to squeeze out as much liquid as possible. Throw the swab away.

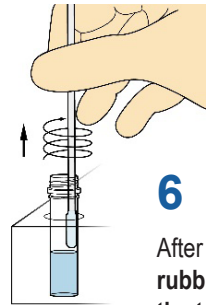

7

Open the Test Strip pouch carefully and put the Test Strip into the open tube with the arrows pointing down. Leave the strip in the tube for 10 minutes. (Use timer or watch!)



Leave strip in at least 10 minutes.

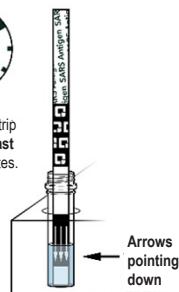

8

After the 10 minutes, take the Test Strip out of the tube and put it on a flat surface with good lighting. Read the Test Strip right away! If you wait longer than 5 minutes to read it, you may get wrong or invalid results.

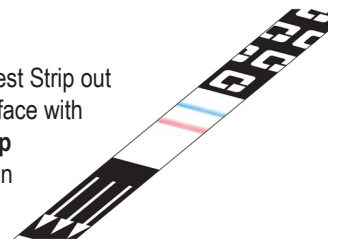

## Reading Your Test Results

There are 3 types of test results possible: **Positive**, **Negative** or **Invalid**, a test that can't be used.

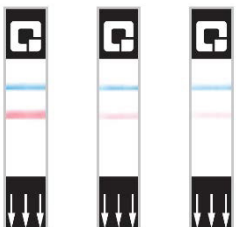

**POSITIVE RESULT = 1 pink line + 1 blue line**  
You are **likely** to have COVID-19. **You should self-isolate.** If you have symptoms that bother or worry you, contact your healthcare provider.



**NEGATIVE RESULT = 1 blue line**  
You are **unlikely** to have COVID-19. But if you have symptoms that bother or worry you, contact your healthcare provider.



**INVALID RESULT = 1 pink line or NO lines**  
You need to **do a new test.** Start again at the beginning using a new tube, swab, and test strip. For 2 invalid results, call 1-833-784-2588.